

1.9"Ø TO 4.5"Ø
ROUND MEMBERS

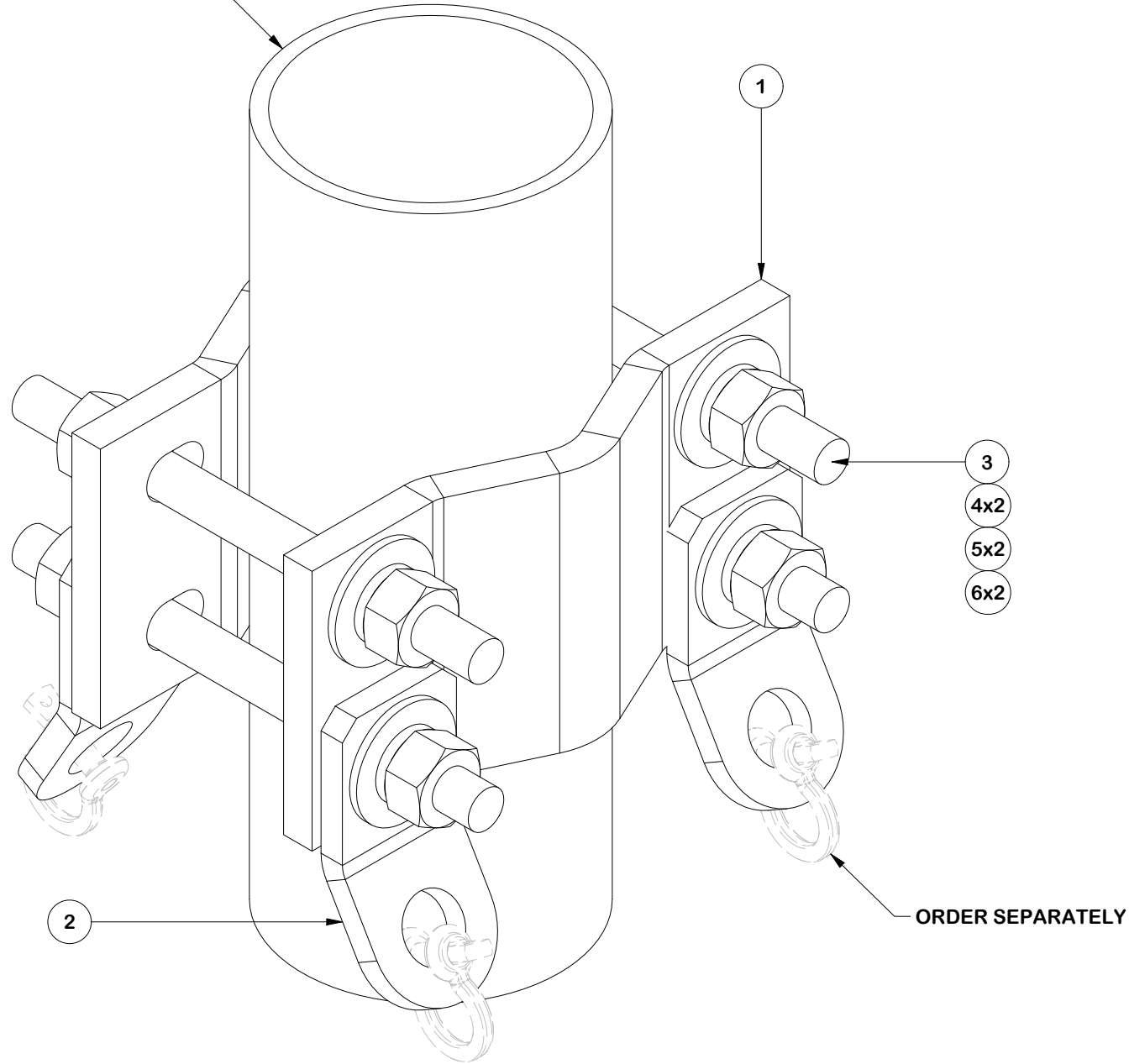

ROUND LEG CONNECTION

2" TO 3-1/2" 90°
ANGLE LEGS

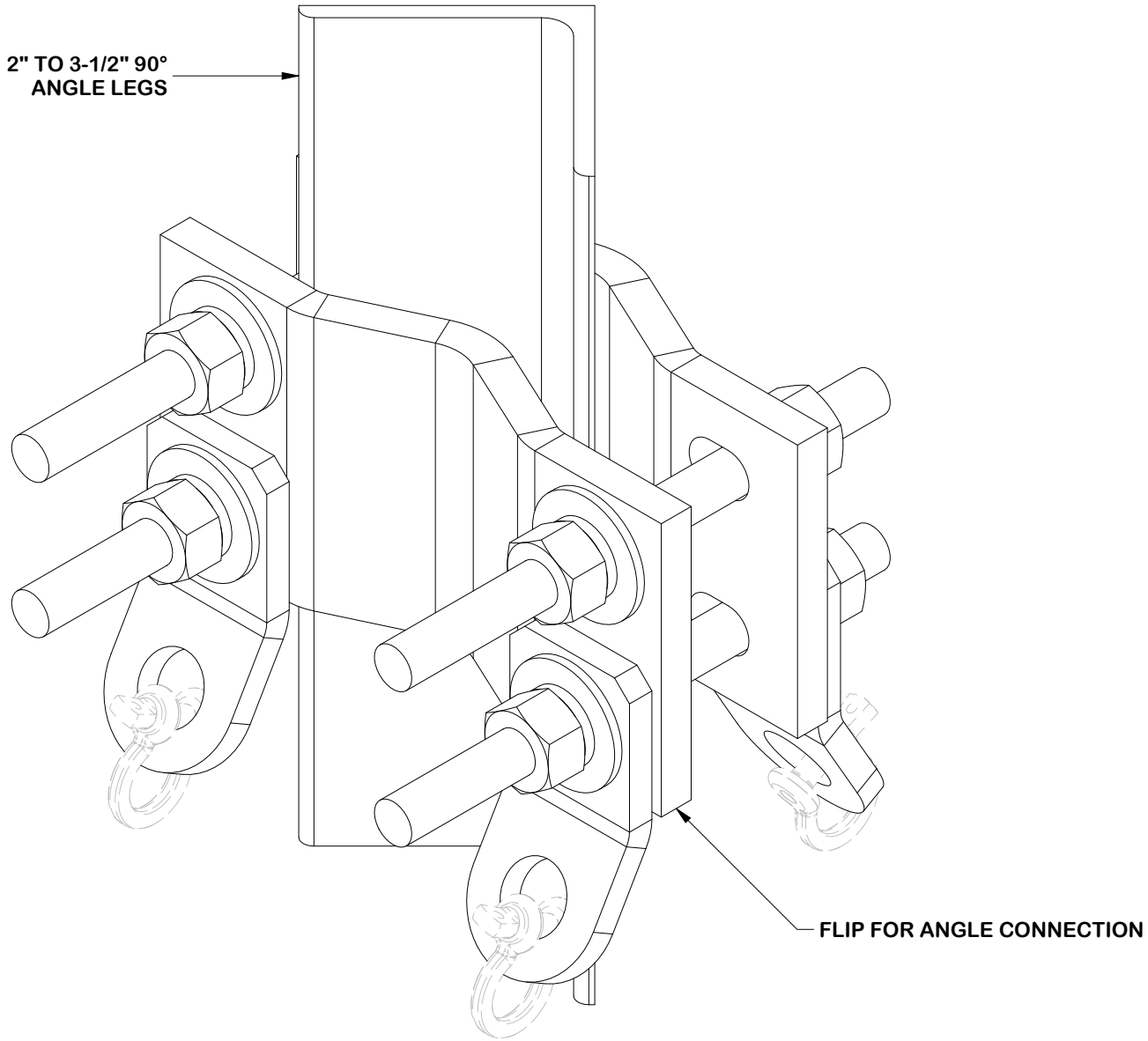

ANGLE LEG CONNECTION

PARTS LIST						
ITEM	QTY	PART NO.	PART DESCRIPTION	LENGTH	UNIT WT.	NET WT.
1	2	V-CLAMP	LARGE V-CLAMP	8 21/32 in	5.55	11.09
2	4	X-TOAB-BPL	TIE-OFF ANCHOR BRACKET BENT PLATE	2 in	0.83	3.33
3	4	G58R-8	5/8" x 8" THREADED ROD (HDG.)		0.70	2.79
4	8	G58FW	5/8" HDG USS FLATWASHER	1/8 in	0.07	0.56
5	8	G58LW	5/8" HDG LOCKWASHER		0.03	0.21
6	8	G58NUT	5/8" HDG HEAVY 2H HEX NUT		0.13	1.04
					TOTAL WT. #	19.02

FINISH:
HOT DIP GALVANIZED.

TOLERANCE NOTES

TOLERANCES ON DIMENSIONS, UNLESS OTHERWISE NOTED ARE:
SAWED, SHEARED AND GAS CUT EDGES ($\pm 0.030"$)
DRILLED AND GAS CUT HOLES ($\pm 0.030"$) - NO CONING OF HOLES
LASER CUT EDGES AND HOLES ($\pm 0.010"$) - NO CONING OF HOLES
BENDS AND ANGLES ARE $\pm 1/2$ DEGREE
ALL OTHER MACHINING ($\pm 0.030"$)
ALL OTHER ASSEMBLY ($\pm 0.060"$)

PROPRIETARY NOTE:
THE DATA AND TECHNIQUES CONTAINED IN THIS DRAWING ARE PROPRIETARY INFORMATION OF VALMONT INDUSTRIES AND CONSIDERED A TRADE SECRET. ANY USE OR DISCLOSURE WITHOUT THE CONSENT OF VALMONT INDUSTRIES IS STRICTLY PROHIBITED.

DESCRIPTION
CABLE HANGER BRACKET
DUAL V-CLAMP W/ FOUR TABS

CPD NO.		DRAWN BY CMFL 5/4/2023		ENG. APPROVAL 5/4/2023	
CLASS 87	SUB 02	DRAWING USAGE CUSTOMER		CHECKED BY BMC 5/4/2023	

SITE
PRO

1

A valmont COMPANY

Engineering
Support Team:
1-888-753-7446

Locations:
New York, NY
Atlanta, GA
Los Angeles, CA
Plymouth, IN
Salem, OR
Dallas, TX
Tampa, FL

PART NO.	CHB-DVC4
DWG. NO.	CHB-DVC4